

# INFORMATION ONLY

# 16454A-01A

# S E R V I C E N O T E

Supersedes:  
16454A-01

## 16454A Magnetic Material Test Fixture

**Serial Numbers: Non-RoHS Fixture “MY43100001 – MY43200586”,  
“SG43100001 – SG43200586”**

**OR**

**RoHS Fixture “MY43200587 – MY43299999”  
“SG43200587 – SG43299999”**

**This service note provides the updated part numbers and figures for both  
RoHS and non- RoHS 16454A Magnetic Material Test Fixture.**

### Parts Required:

Please refer to table 1-1, 1-2.

## ADMINISTRATIVE INFORMATION

SERVICE NOTE CLASSIFICATION:	
<b>INFORMATION ONLY</b>	
<input type="checkbox"/> Calibration Required	PRODUCT LINE: WN
<input checked="" type="checkbox"/> Calibration NOT Required	AUTHOR: LS
ADDITIONAL INFORMATION: Support part information for non-RoHS and RoHS 16454A Magnetic Material Test Fixture	

**Situation:**

**For both RoHS and non-RoHS 16454A Magnetic Material Test Fixture.**

**Solution/Action:**

Shown are the support parts for RoHS and non-RoHS compliance 16454A Magnetic Material Test Fixture. All the listed items are changed at RoHS conversion. Due to limited availability of RoHS compliance station and technical difficulties in RoHS soldering, only parts and support level that do not require RoHS soldering are supported. Shown are the supported RoHS compliance parts for 16454A Magnetic Material Test Fixture.

Shown in table 1-1 and figure 1-1 are the items included with the 16454A Magnetic Material Test Fixture.

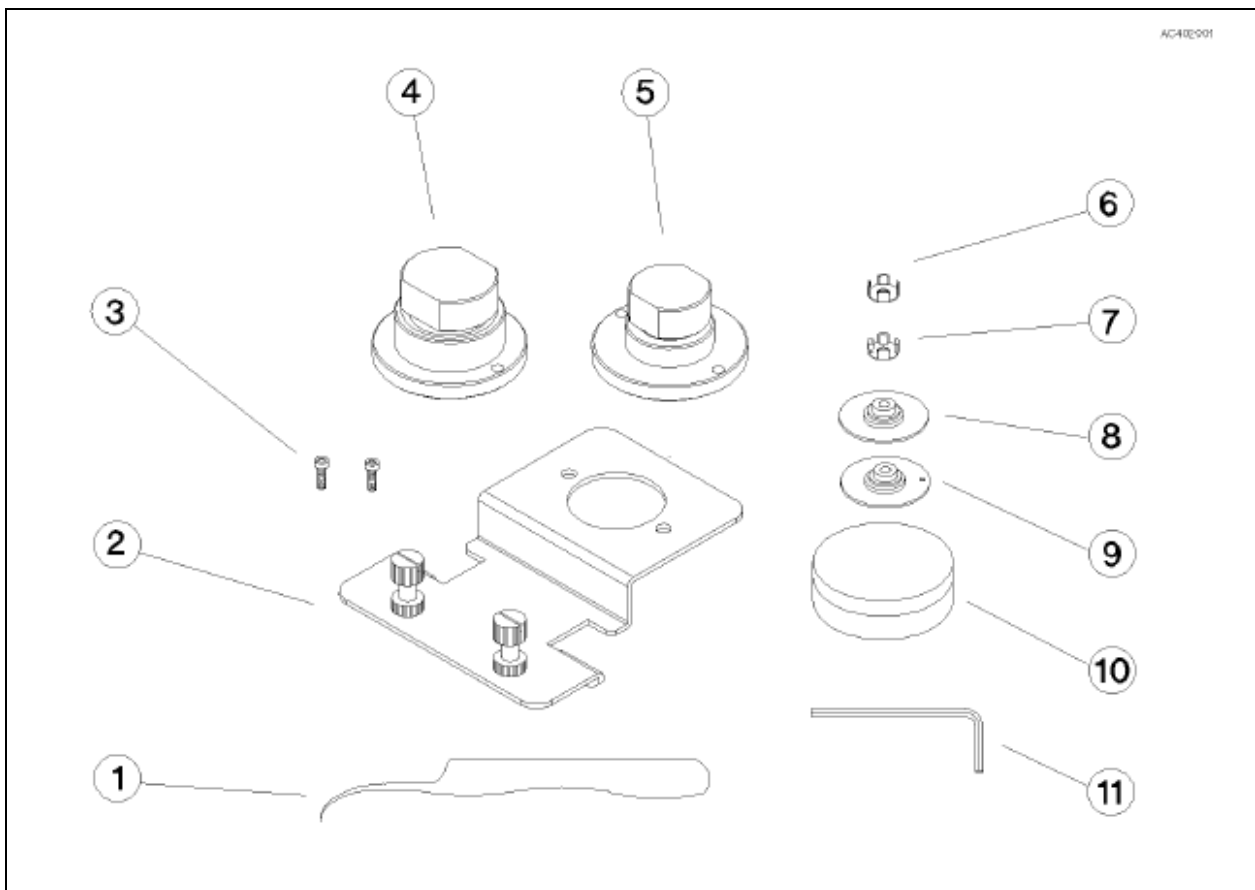

**Figure 1-1**

**NOTE: For RoHS Compliant Upper Level Assembly Replacement Part, if multiple parts are replaced by a common higher level assembly, only order ONE part of the higher level common assembly.**

**Table 1-1:**  
16454A Contents

<b>Ref/D</b>	<b>Part Number</b>	<b>Qty.</b>	<b>Description</b>	<b>RoHS Compliant Replacement Part</b>	<b>Qty.</b>
1	8710-2081	1	Tweezers	8710-2081	1
2	16454-00601	1	Fixture Holder	16454-00601	1
3	0515-1050	2	Screw, Hex Recess	0515-1050	2
4	(not assigned)	1	Test fixture (Large)	(not assigned)	1
5	(not assigned)	1	Test fixture (Small)	(not assigned)	1
6	16454-25002	1	Holder A	16454-25002	1
7	16454-25001	1	Holder B	16454-25001	1
8	16454-25004	1	Holder C (WITHOUT HOLE)	16454-25004	1
9	16454-25003	1	Holder D (WITH HOLE)	16454-25003	1
10	1540-0622	1	Holder Case	9300-2603	1
11	5188-4452	1	Hex Key, 2.5 mm Across Flats	5188-4452	1
-	16454-60101	1	Carrying Case <sup>1</sup>	16454-60101	1
-	16454-90020	1	Operation and Service Manual <sup>1</sup>	16454-90020	1

<sup>1</sup> These parts are not shown in this figure.

Shown in table 1-2 is the replaceable parts list for both RoHS and non RoHS compliance 16454A.

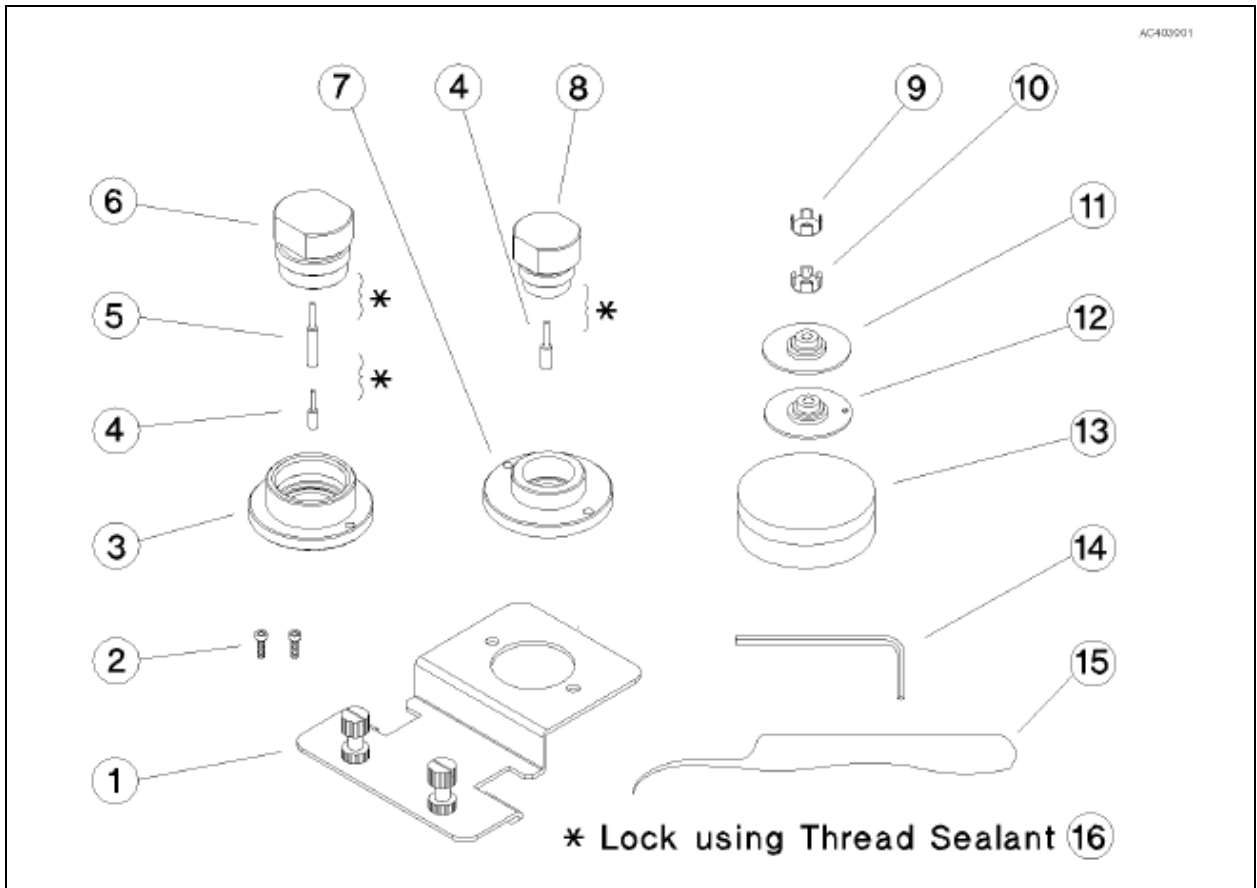

Figure 1-2

**Table 1-2:**  
Replaceable Parts for Main Assembly

Ref/D	Part Number	Qty.	Description	RoHS Compliant Replacement Part	Qty.
1	16454-00601	1	Length Positioning Stage Assembly	16454-00601	1
2	0515-1050	2	Screw, Hex Recess	0515-1050	2
3	16454-23004	1	Fixture Flange (Large)	16454-23004	1
4	1250-0816	2	Conn-RF Conn	1250-0816	2
5	16454-23005	1	Center Pin	16454-23005	1
6	16454-23003	1	Fixture Cap (Large)	16454-23003	1
7	16454-23002	1	Fixture Flange (Small)	16454-23002	1
8	16454-23001	1	Fixture Cap (Small)	16454-23001	1
9	16454-25002	1	Holder A	16454-25002	1
10	16454-25001	1	Holder B	16454-25001	1
11	16454-25004	1	Holder C (WITHOUT HOLE)	16454-25004	1
12	16454-25003	1	Holder D (WITH HOLE)	16454-25003	1
13	1540-0622	1	Holder Case	9300-2603	1
14	5188-4452	1	Hex Key, 2.5 mm Across Flats	5188-4452	1
15	8710-2081	1	Tweezers	8710-2081	1
16	0470-0013	1	Thread Sealant	0470-0013	1
-	16454-60101	1	Carrying Case <sup>1</sup>	16454-60101	1
-	16454-90020	1	Operation and Service Manual <sup>1</sup>	16454-90020	1

<sup>1</sup> These parts are not shown in this figure.

**Note:**

Perform Function Test to check the 16454A performance after repair. The functional test is used for post-repair function verification. (Refer to 16454A Magnetic Material Test Fixture Operation and Service Manual Chapter 5.)

**Revision History:**

Service note Revision	Date	Author	Reason For Change
16454A-01	9-Jul-2012	ls	As published
16454A-01A	7-Aug-2014	jm	Add non-RoHS and RoHS serial-numbers