

# E4991A-05

# S E R V I C E N O T E

Supersedes:  
NONE

## E4991A-007 Temperature Characteristic Test Kit

**Serial Numbers:** ALL

**This service note provides the updated part numbers and figures for both RoHS and non-RoHS E4991A-007 Temperature Characteristic Test Kit.**

**Parts Required:**

Details refer to table 1-1 shown below.

### ADMINISTRATIVE INFORMATION

SERVICE NOTE CLASSIFICATION:	
<b>INFORMATION ONLY</b>	
<input checked="" type="checkbox"/> Calibration Required	PRODUCT LINE: WN
<input type="checkbox"/> Calibration NOT Required	AUTHOR: LS
ADDITIONAL INFORMATION: Support part information for E4991A-007 Temperature Characteristic Test Kit.	

© AGILENT TECHNOLOGIES, INC. 2013  
PRINTED IN U.S.A.

May 7, 2013

Rev. 21



**Situation:**

**For both RoHS and non-RoHS E4991A-007 Temperature Characteristic Test Kit.**

**Solution/Action:**

Shown are the support parts for RoHS and non-RoHS compliance E4991A-007 Temperature Characteristic Test Kit. All the listed items are changed at RoHS conversion. Due to limited availability of RoHS compliance station and technical difficulties in RoHS soldering, only parts and support level that do not require RoHS soldering are supported. Shown are the supported RoHS compliance parts for E4991A-007 Temperature Characteristic Test Kit.

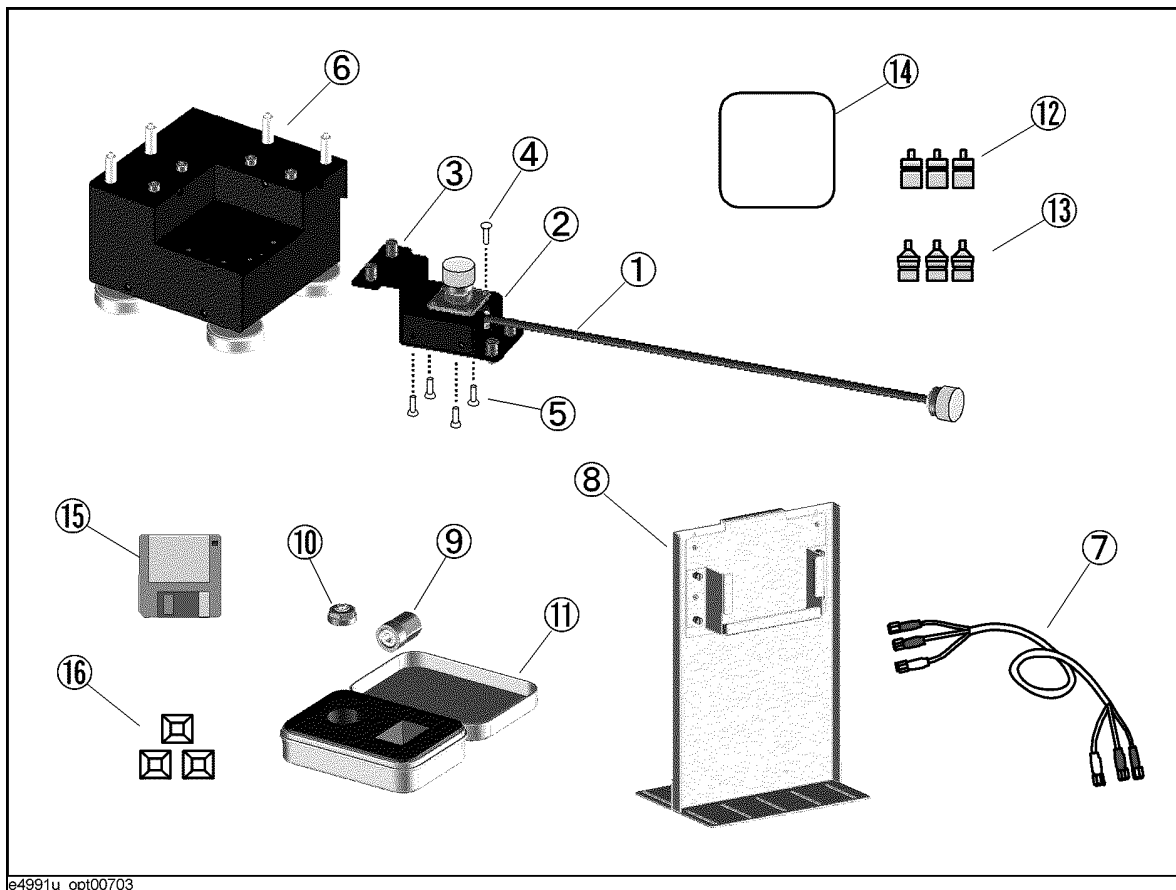

**Figure 1-1**

**NOTE: For RoHS Compliant Upper Level Assembly Replacement Part, if multiple parts are replaced by a common higher assembly part, only order ONE part of the higher level common assembly.**

Shown in table 1-1 are the original support part and its compatible RoHS replacement part/assembly.

**Table 1-1: Replaceable Parts for Main Assembly**

Ref/D	Part Number	Description	Qty.	RoHS Compliant Replacement Part	Description	Qty.
1	E4991-61610	CABLE ASSY HEAT-RESISTANT	1	E4991-61610	CABLE ASSY HEAT-RESISTANT	1
2	E4991-01220	HOLDER CABLE	1	E4991-01220	HOLDER CABLE	1
3	E4991-01221	HOLDER CABLE	1	E4991-01221	HOLDER CABLE	1
4	0515-0372	SCREW-MACH M3X8 TORX T10 PAN	4	0515-0372	SCREW-MACH M3X8 TORX T10 PAN	4
5	0515-1946	SCREW-MACH M3X6 TORX T10 90 DEG FLAT	4	0515-1946	SCREW-MACH M3X6 TORX T10 90 DEG FLAT	4
6	E4991-60005	STAND TEST- FIXTURE	1	E4991-60005	STAND TEST- FIXTURE	1
7	04287-61651	RF CABLE ASSY EXTENSION	1	04287-61651	RF CABLE ASSY EXTENSION	1
8	E4991-60006	STAND TEST- HEAD	1	E4991-60006	STAND TEST- HEAD	1
9	E4991-60032	TERMINATION OPEN	1	E4991-60032	TERMINATION OPEN	1
10	E4991-60031	TERMINATION SHORT	1	E4991-60031	TERMINATION SHORT	1
11	E4991-60060	CASE TEMPERATURE- COMPENSATION- SET	1	E4991-60060	CASE TEMPERATURE- COMPENSATION -SET	1
12	1250-2879	ADAPTER N (M) - SMA (F)	3	1250-1250	ADAPTER N (M) - SMA (F)	3
13	1250-3157	ADAPTER N (F) - SMA (F)	3	1250-1404	ADAPTER N (F) - SMA (F)	3
14	04291-09001	PAD	1	04291-09001	PAD	1
15	E4991-18001 (E4991-01220)	DISK FLOPPY TEMP-CHARAC- TEST SOFTWARE	1	E4991-18002	DISK FLOPPY TEMP-CHARAC- TEST SOFTWARE	1
16	1400-0584	TIE CABLE	3	1400-0584	TIE CABLE	3

**Post Repair Procedure**

Refer to E4991A Service Guide Chapter 2 → Performance Test and Function Test → Performance Test (for Option 007 Temperature Characteristic Test Kit) on the post repair requirements.

**Revision History:**

Revision Number	Date	Author	Reason For Change
1.0	7 May 2013	LS	As published