

INFORMATION ONLY

E5063A-03

S E R V I C E N O T E

Supersedes:
None

E5063A – ENA Series Network Analyzer

Serial Numbers: ALL

E5063A Chassis Assembly and Rear Panel replacement part number change.

Parts Required:

P/N	Description	Qty.
E5061-60026	Chassis Assembly	1
E5061-00218	Rear Panel	1

ADMINISTRATIVE INFORMATION

SERVICE NOTE CLASSIFICATION:

INFORMATION ONLY

Calibration Required

Calibration NOT Required

PRODUCT LINE: WN

AUTHOR: LS

ADDITIONAL INFORMATION:

This service note communicates the rear panel and chassis assembly support parts replacement strategy and dependency.

Situation:

New and improved rear panel and chassis assembly is introduced. Due to mechanical (dimension) change, both rear panel and chassis assembly are required to be replaced with “new” part number on hardware compatibility when either one of the “old” part number is depleted.

Solution/Action:

The new and improved rear panel and chassis assembly would to further improve the grip between the rear panel and chassis assembly. The insert nut of the chassis assembly is made to be slightly protruded (~1.2mm) resulting in the direct contact (same surface level) when the rear panel (~1.2mm in thickness) is installed.

Replace **both** rear panel and chassis assembly whenever one of the following old part is required to be replaced. Shown in Table 1-1 is the replacement part support plan for E5063A. Refer to Figure 1-1 for the detailed illustration on the changes.

Table 1-1

Defective PN (Old)	Replacing PN (New)	Description	Remarks
E5061-60006	1. E5061-60026 & 2. E5061-00218	Chassis Assembly	Set Replacement
E5061-00208		Rear panel	

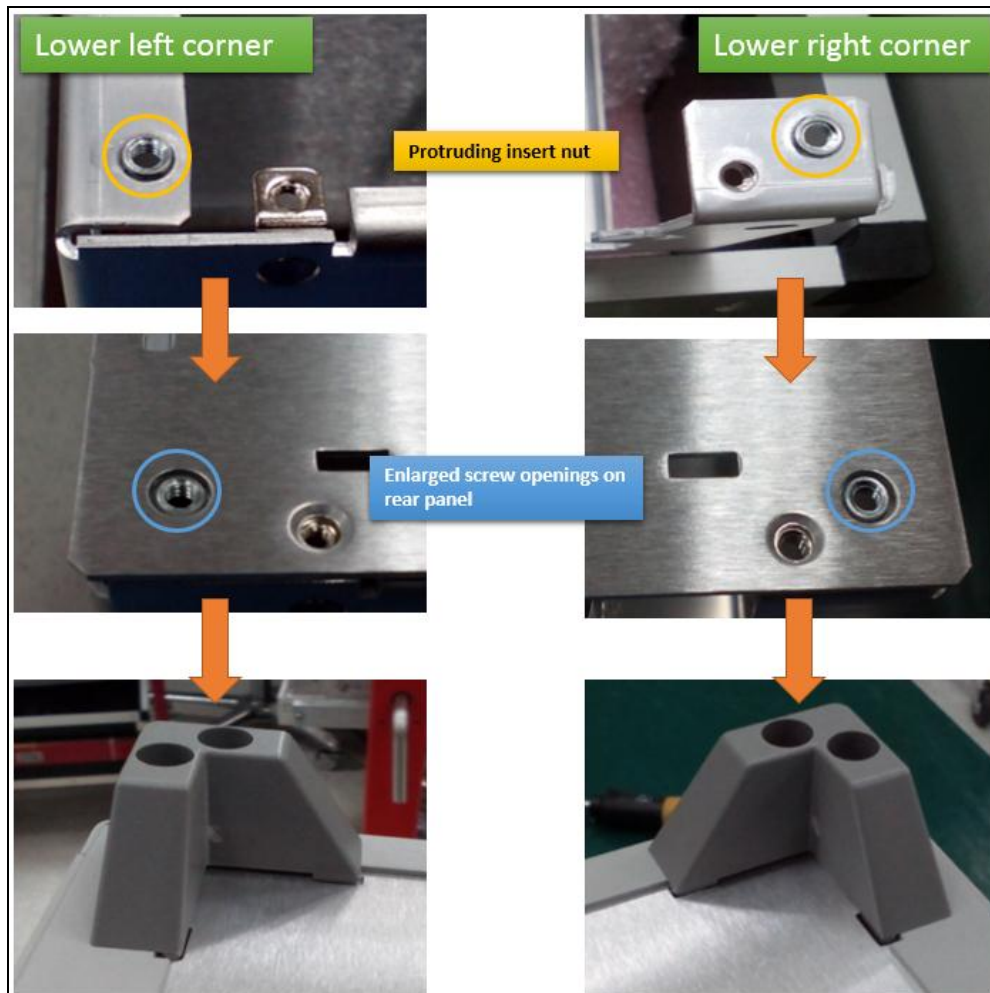

Figure 1-1 New Rear panel and Chassis assembly

Post replacement requirement:

Perform full calibration in ensuring the instrument is well within specification since the chassis assembly replacement would require the removal and assembly of analog modules.

Revision History:

Service note Revision	Date	Author	Reason For Change
E5063A-03	25 May 2015	ls	As published